

FACT SHEET

SOLD

PROPERTY ADDRESS: COOK DR ROCHESTER NY,14623

MINIMUM OPENING BID: \$12,500

TOWN: HENRIETTA
TAX MAP #: 161.11-1-22.115; 22.116 AND 22.117

CURRENT ASSESSED VALUE: \$200,900 (3 PARCEL TOTAL)
CURRENT TAXES: \$6,619.04 (3 PARCEL TOTAL)

LAND USE CODE: 340
TOTAL SITE SIZE: 15.15 ACRES (3 PARCEL TOTAL)
ROAD FRONTAGE: SEE TAX MAP
AVAILABLE UTILITIES:

GAS/ELEC:	GAS & ELECTRIC
WATER:	COMM/PUBLIC
SEWER	COMM/PUBLIC

OTHER: UNIMPROVED

THE COUNTY IS SELLING THIS PARCEL IN "AS IS" CONDITION. IT IS THE RESPONSIBILITY OF THE PURCHASER TO DETERMINE THE PERMITTED USE OF THIS PARCEL AND COMPLY WITH ANY AND ALL TOWN ZONING AND BUILDING CODES.

INFORMATION GIVEN HERE IS FOR INFORMATIONAL PURPOSES ONLY. THESE FACTS AND FIGURES ARE SUBJECT TO CHANGES AND ARE THEREFORE DISCRETIONARY. POTENTIAL BUYERS ARE RESPONSIBLE TO PERFORM THEIR OWN DUE DILIGENCE.

THE SELLER (MONROE COUNTY), NEITHER GUARANTEES NOR WARRANTIES ANYTHING AS TO THE LOCATION, DIMENSION, PARCEL USE OR SIZE. IT IS THE SOLE RESPONSIBILITY OF THE PURCHASER TO DETERMINE THE LEGAL AND/OR PHYSICAL FITNESS OF THE PROPERTY.

141- 1168-1170
161.11-1- 22.115
et al

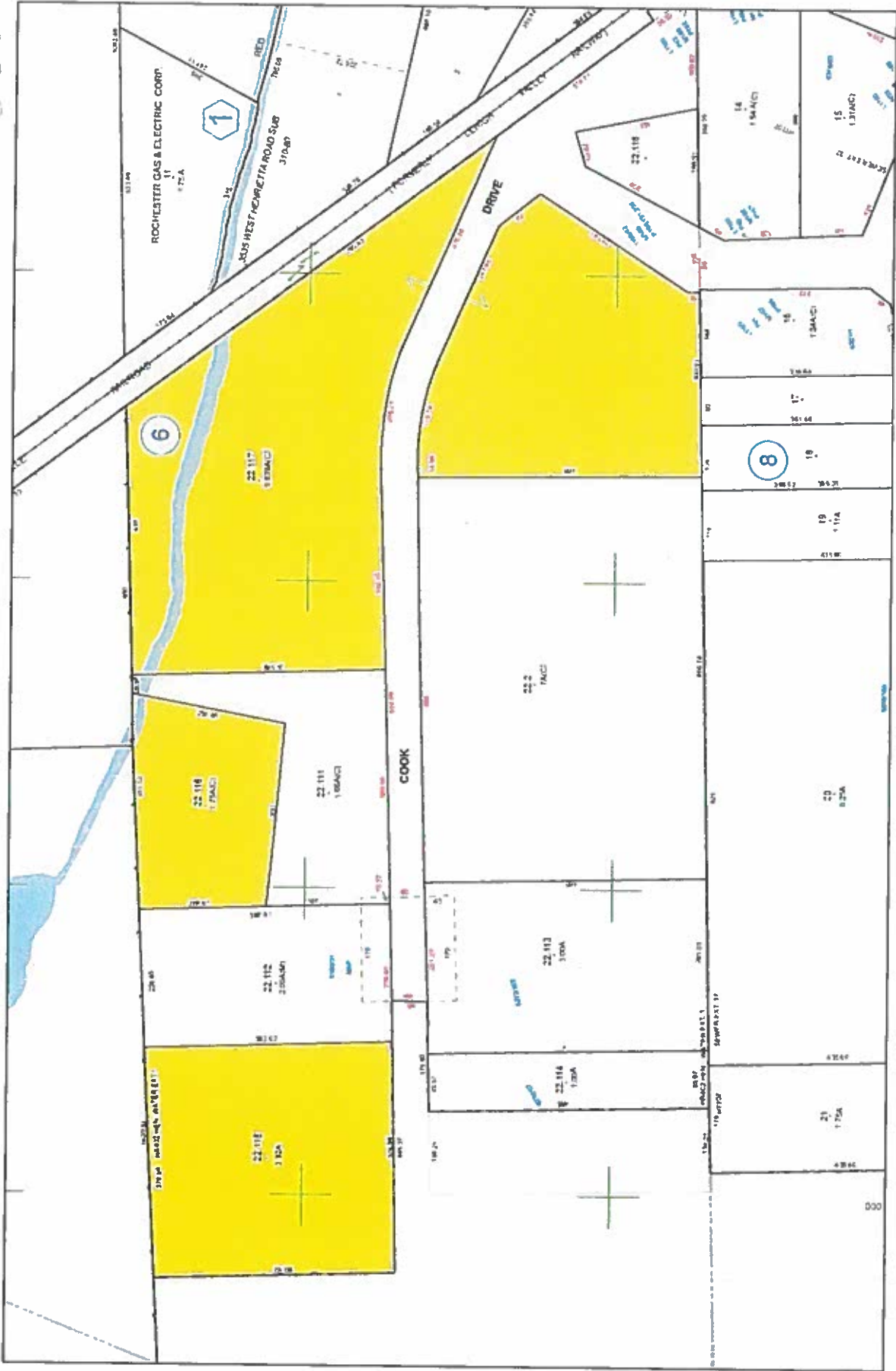

FACT SHEET

PROPERTY ADDRESS: WEST HENRIETTA RD

MINIMUM OPENING BID: \$12,350

TOWN: HENRIETTA

TAX MAP #: 188.04-1-16

CURRENT ASSESSED VALUE: \$35,400

CURRENT TAXES: \$1,137.31

LAND USE CODE: 311

TOTAL SITE SIZE: 4.94 ACRE

ROAD FRONTAGE: SEE TAX MAP

AVAILABLE UTILITIES:

GAS/ELEC: GAS & ELECTRIC

WATER: COMM/PUBLIC

SEWER: NONE

OTHER: UNIMPROVED

THE COUNTY IS SELLING THIS PARCEL IN "AS IS" CONDITION. IT IS THE RESPONSIBILITY OF THE PURCHASER TO DETERMINE THE PERMITTED USE OF THIS PARCEL AND COMPLY WITH ANY AND ALL TOWN ZONING AND BUILDING CODES.

INFORMATION GIVEN HERE IS FOR INFORMATIONAL PURPOSES ONLY. THESE FACTS AND FIGURES ARE SUBJECT TO CHANGES AND ARE THEREFORE DISCRETIONARY. POTENTIAL BUYERS ARE RESPONSIBLE TO PERFORM THEIR OWN DUE DILIGENCE.

THE SELLER (MONROE COUNTY), NEITHER GUARANTEES NOR WARRANTIES ANYTHING AS TO THE LOCATION, DIMENSION, PARCEL USE OR SIZE. IT IS THE SOLE RESPONSIBILITY OF THE PURCHASER TO DETERMINE THE LEGAL AND/OR PHYSICAL FITNESS OF THE PROPERTY.

141-1180
188.04-1-16

1"=100' SCALE
SEE MAP 188.20

HR 402 HEN. WATER EXT. 1

WEST HENRIETTA ROAD U.S. RTE. 15

N1,104,000

30

29

